

AENC-LSTC-ENG-DWG-0003

# Norwich to Tilbury

**Volume 2: Plans, Drawings and Sections**

**Document: 2.3 Works Plans - Section G - Tracked Changes  
Version**

**Final Issue B**

**June 2026**

**Planning Inspectorate Reference: EN020027**

Infrastructure Planning (Applications: Prescribed Forms and Procedure)  
Regulations 2009 Regulation 5(2)(j)

**nationalgrid**

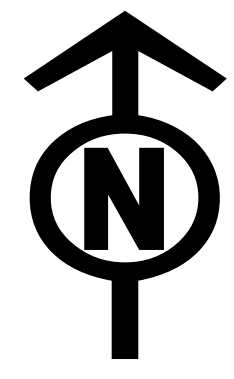

THE NATIONAL GRID (NORWICH TO TILBURY) ORDER  
WORKS PLANS KEY PLAN  
REGULATION 5(2)(j)  
SECTION G (SHEET 1 OF 1,  
CHELMSFORD CITY COUNCIL, BRENTWOOD BOROUGH COUNCIL, BASILDON BOROUGH COUNCIL AND THURROCK COUNCIL)

Application Document 2.3

SITE MAP

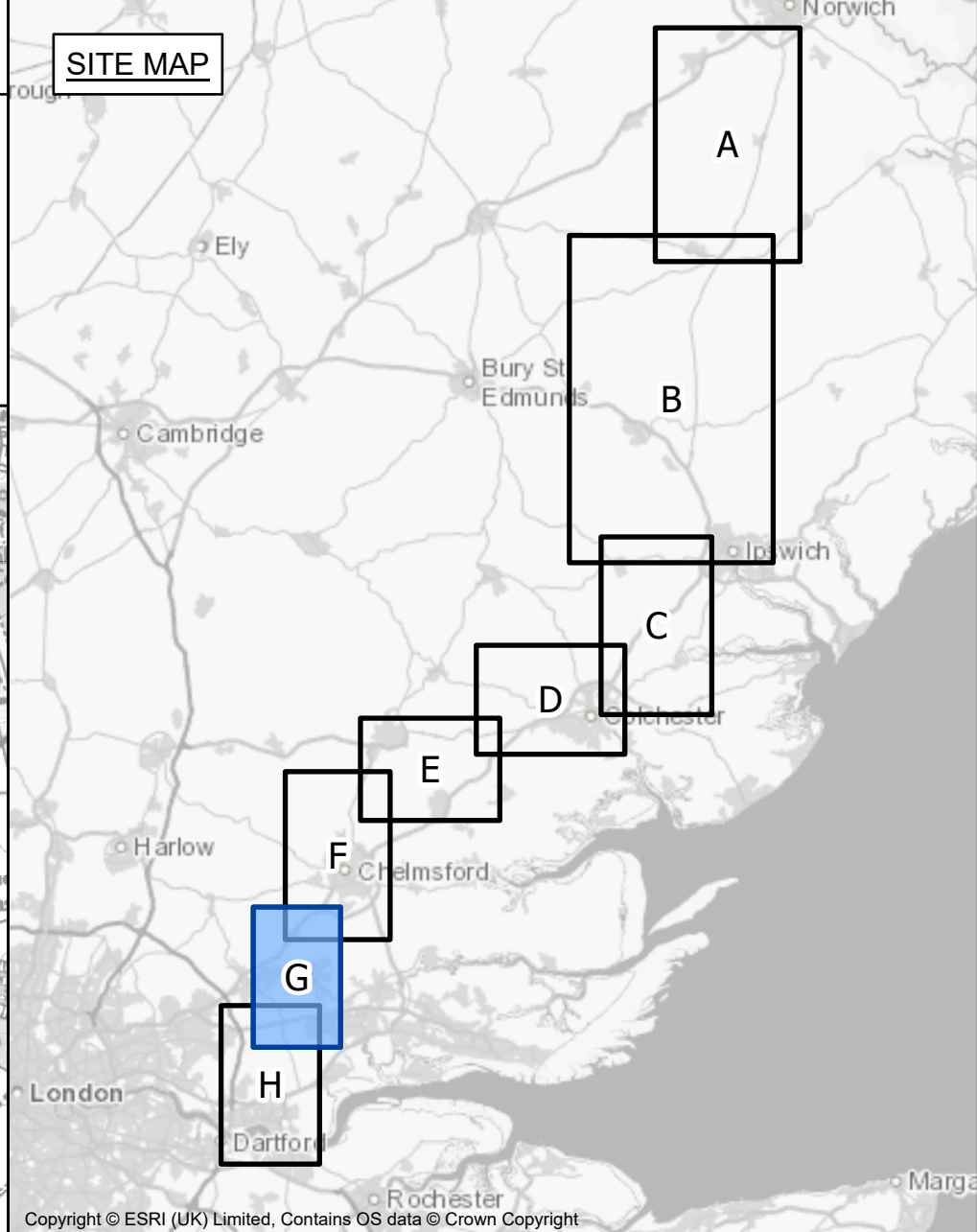

CHELMSFORD CITY COUNCIL, BRENTWOOD BOROUGH COUNCIL, BASILDON BOROUGH COUNCIL AND THURROCK COUNCIL

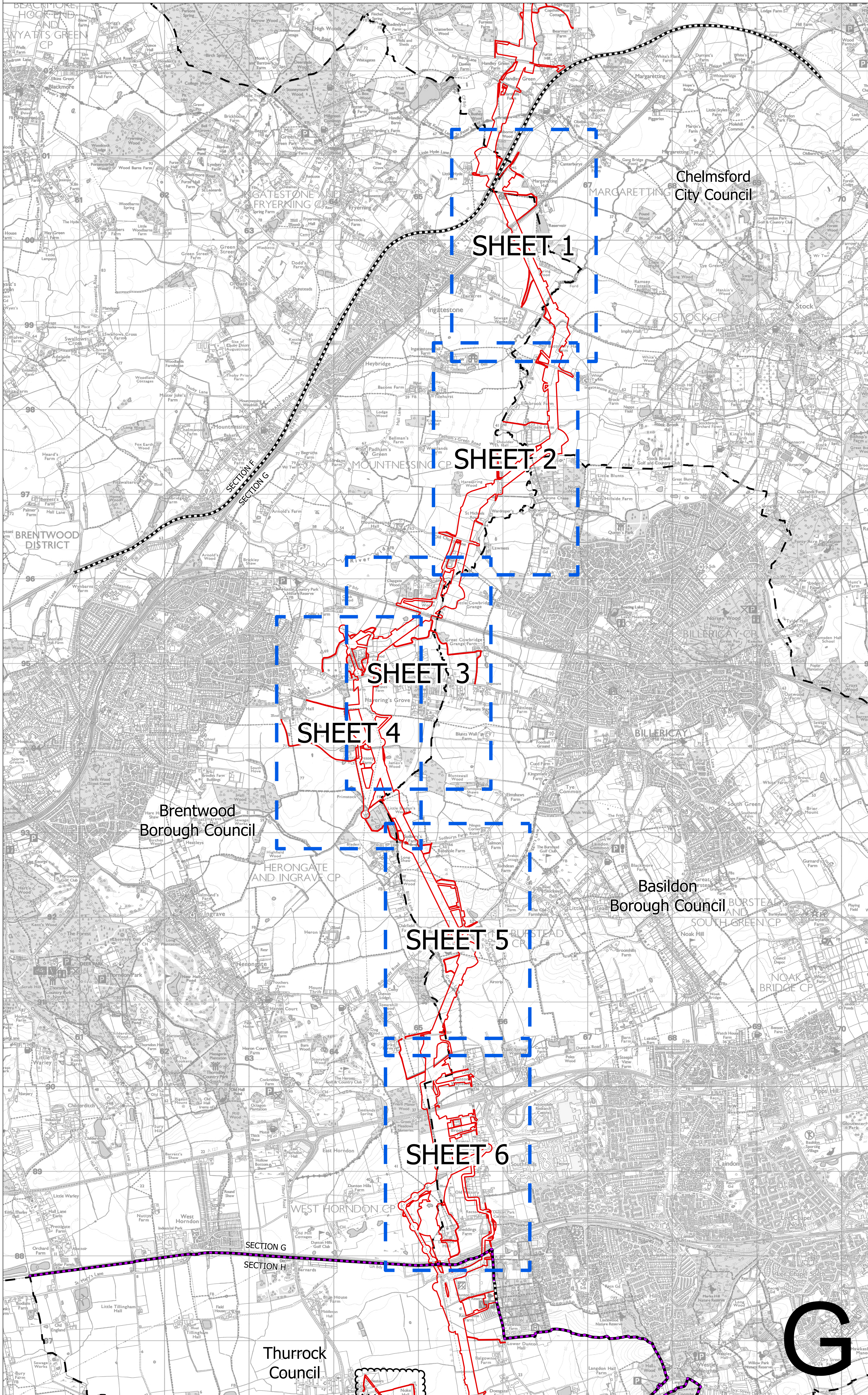

- Legend**
- Local authority boundary
  - Section boundary & local authority boundary
  - Section boundary
  - Sheet Index
  - Order Limits

- Notes**
1. These plans show the Order Limits and potential location for the works. Due to the need for future flexibility, National Grid will be applying for Order Limits and Limits of Deviation within its Development Consent Order, within which any final alignments will be.
  2. For additional detail on the plan suites, please refer to the Guide to Plans (document reference 2.0), located in the Volume 2 of the DCO application.
  3. This drawing is scaled at paper size A0, therefore any prints taken at smaller sizes will affect accuracy of the measurement units and should not be scaled against.

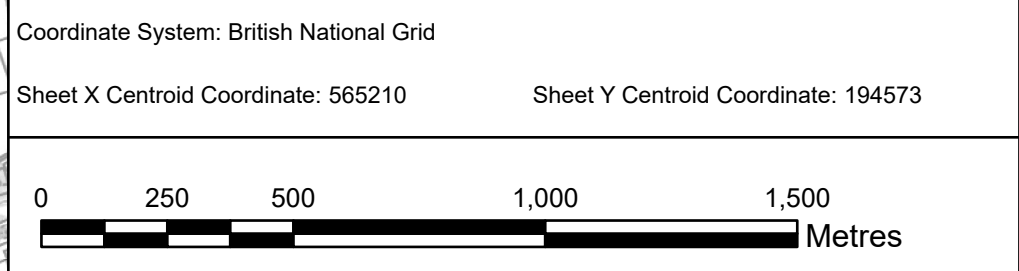

BACKGROUND MAPPING INFORMATION HAS BEEN REPRODUCED FROM THE ORDNANCE SURVEY BY PERMISSION OF ORDNANCE SURVEY OF THE CONTROLLER OF HIS MAJESTY'S STATIONERY OFFICE. © CROWN COPYRIGHT AND DATABASE RIGHTS (2025) LICENCE OS100024241 AND AC0000807948.

B	JUN-2026	For deadline five	TMH	JPC	KR
A	AUG-2025	For DCO submission	MAB	JPC	KR
Issue	Date	Remarks	Drawn	Checked	Approved

**Title**  
THE NATIONAL GRID (NORWICH TO TILBURY) ORDER  
WORKS PLANS KEY PLAN  
REGULATION 5(2)(j)  
SECTION G (SHEET 1 OF 1,  
CHELMSFORD CITY COUNCIL,  
BRENTWOOD BOROUGH COUNCIL,  
BASILDON BOROUGH COUNCIL  
AND THURROCK COUNCIL)

**nationalgrid**  
PINS Application Number  
EN020027

National Grid Drawing Reference  
AENC-LSTC-ENG-DWG-0003

Scale	Sheet Size	Sheet	Issue
1:15,000	A0	SHEET 1 OF 1	B



THE NATIONAL GRID (NORWICH TO TILBURY) ORDER  
WORKS PLANS  
REGULATION 5(2)(j)  
SECTION G (SHEET 1 OF 6,  
CHELMSFORD CITY COUNCIL AND BRENTWOOD BOROUGH COUNCIL)

Application Document 2.3

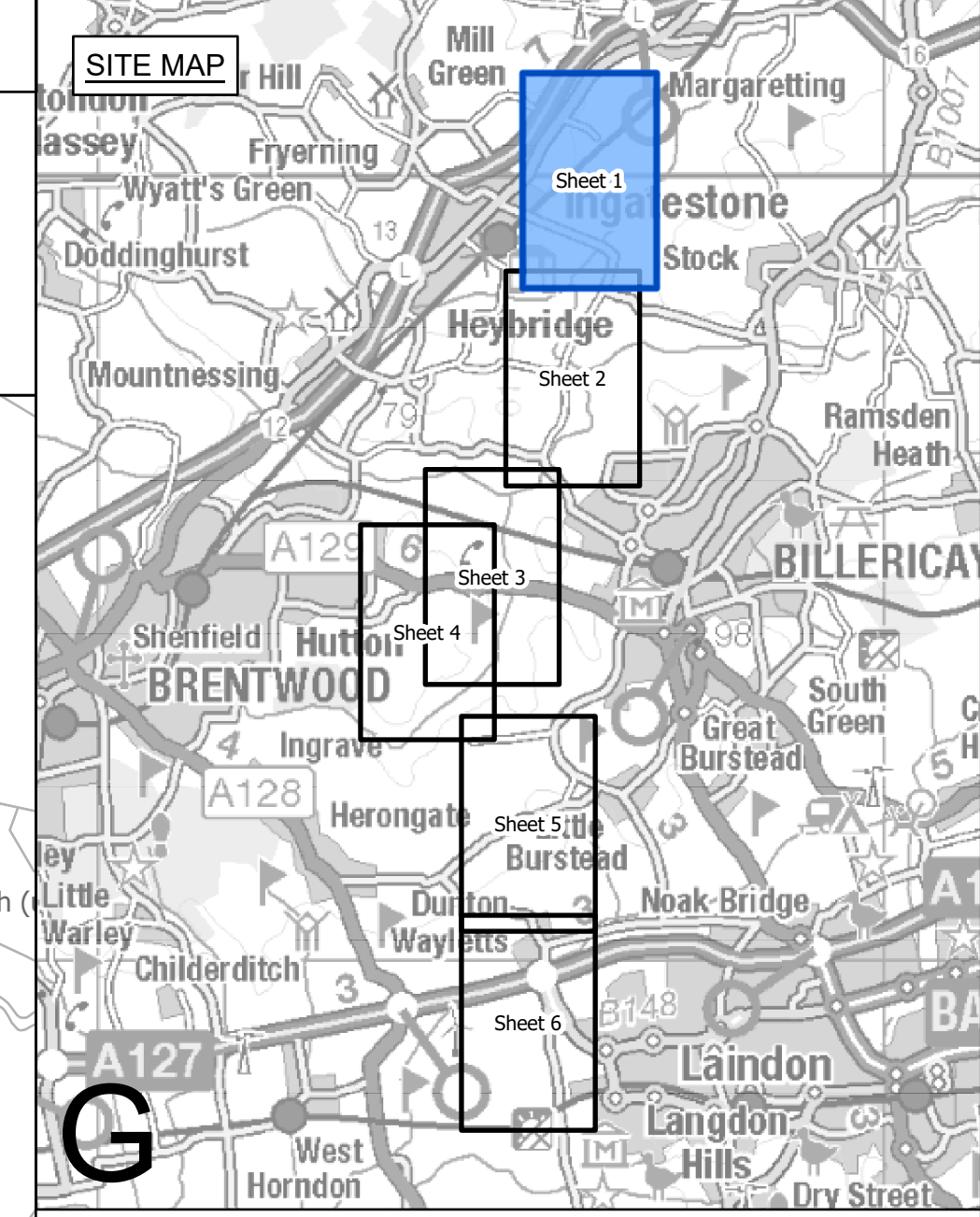

- Legend**
- Local authority boundary
  - Section boundary & local authority boundary
  - Section boundary
  - Sheet index cutlines
  - Commencement of work
  - Termination of work
  - Order Limits
  - Limits of deviation: overhead lines
  - Limits of deviation: underground cables
  - Limits of deviation: non-linear works
  - ✕ Proposed lattice pylons (not to scale)
  - ✕ Proposed pylon removal (not to scale)
  - ✕ Proposed pylon modification (not to scale)
  - ✕ Proposed temporary pylon (angle structures only) (not to scale)
  - Proposed overhead line
  - Third party overhead line to be removed
  - Third party existing overhead line (modified)
  - Third party proposed overhead line
  - Third party temporary overhead line diversion
  - Third party proposed underground cable centreline
  - Proposed substation extension

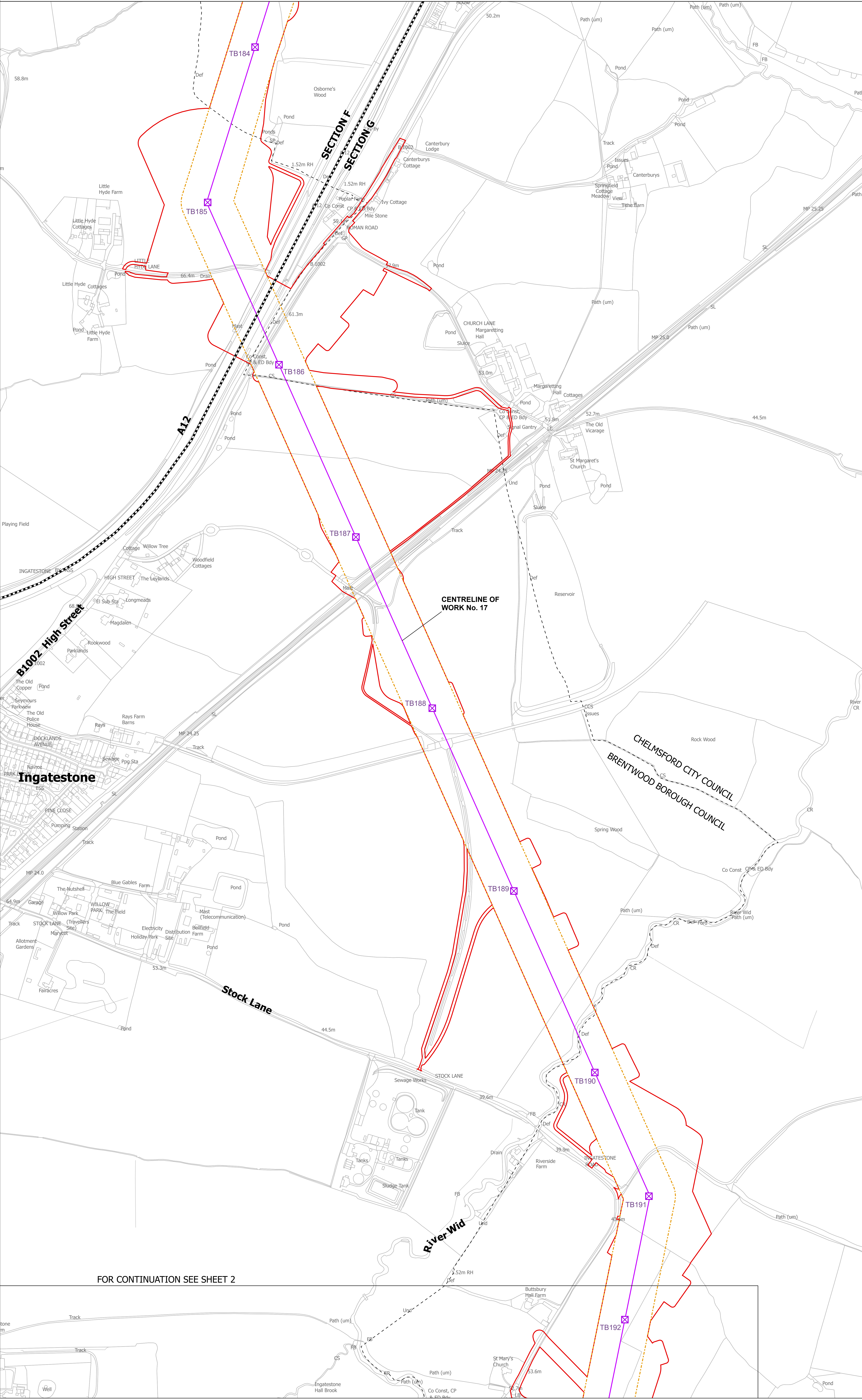

**Notes**

- These plans are indicative and the Project will sit within the Order Limits. Due to the need for future flexibility, National Grid will be applying for Order Limits and Limits of Deviation within its DCO, within which any final alignment would lie.
- For additional detail on the plan suites, please refer to the Guide to Plans (document reference 2.0), located in the Volume 2 of the DCO application.
- This drawing is scaled at paper size A0, therefore any prints taken at smaller sizes will affect accuracy of the measurement units and should not be scaled against.

Coordinates System: British National Grid  
Sheet X Centroid Coordinate: 566248 Sheet Y Centroid Coordinate: 199936

BACKGROUND MAPPING INFORMATION HAS BEEN REPRODUCED FROM THE ORDNANCE SURVEY BY PERMISSION OF ORDNANCE SURVEY OF THE CONTROLLER OF HIS MAJESTY'S STATIONERY OFFICE. © CROWN COPYRIGHT AND DATABASE RIGHTS (2025) LICENCE OS100024241 AND AC0000807948.

Issue	Date	Remarks	Drawn	Checked	Approved
B	JUN-2026	For deadline five	TMH	JPC	KR
A	AUG-2025	For DCO submission	MAB	JPC	KR

**Title**

THE NATIONAL GRID (NORWICH TO TILBURY) ORDER  
WORKS PLANS  
REGULATION 5(2)(j)  
SECTION G (SHEET 1 OF 6,  
CHELMSFORD CITY COUNCIL  
AND BRENTWOOD BOROUGH COUNCIL)

**nationalgrid**

PINS Application Number: EN020027

National Grid Drawing Reference: AENC-LSTC-ENG-DWG-0003

Scale	Sheet Size	Sheet	Issue
1:2,500	A0	SHEET 1 OF 6	B

FOR CONTINUATION SEE SHEET 2

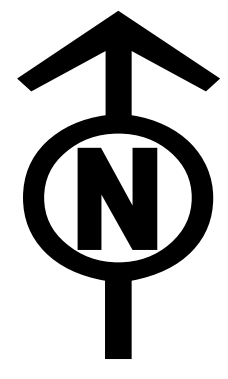

THE NATIONAL GRID (NORWICH TO TILBURY) ORDER  
WORKS PLANS  
REGULATION 5(2)(j)  
SECTION G (SHEET 2 OF 6,  
BRENTWOOD BOROUGH COUNCIL, CHELMSFORD CITY COUNCIL AND BASILDON BOROUGH COUNCIL)

Application Document 2.3

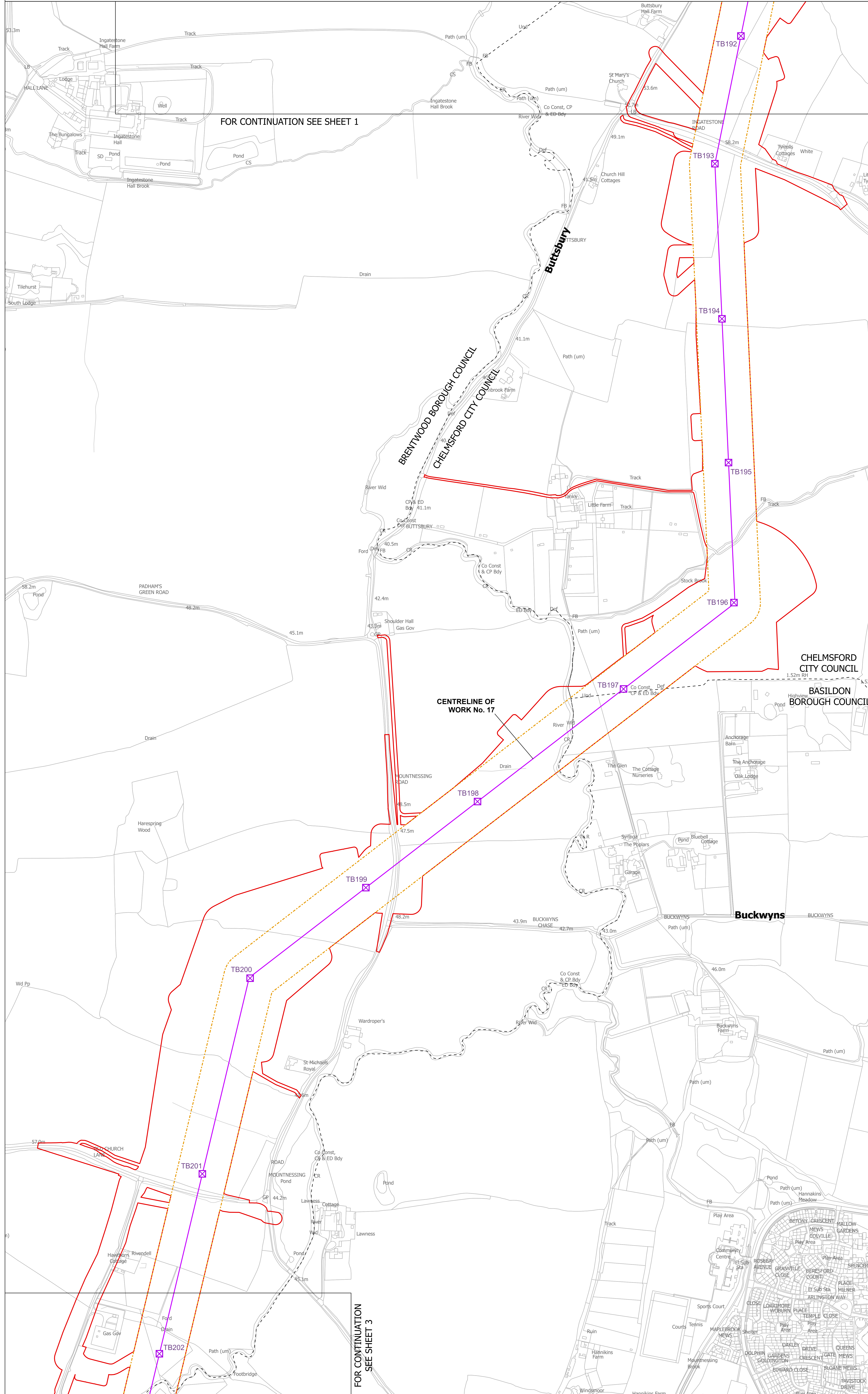
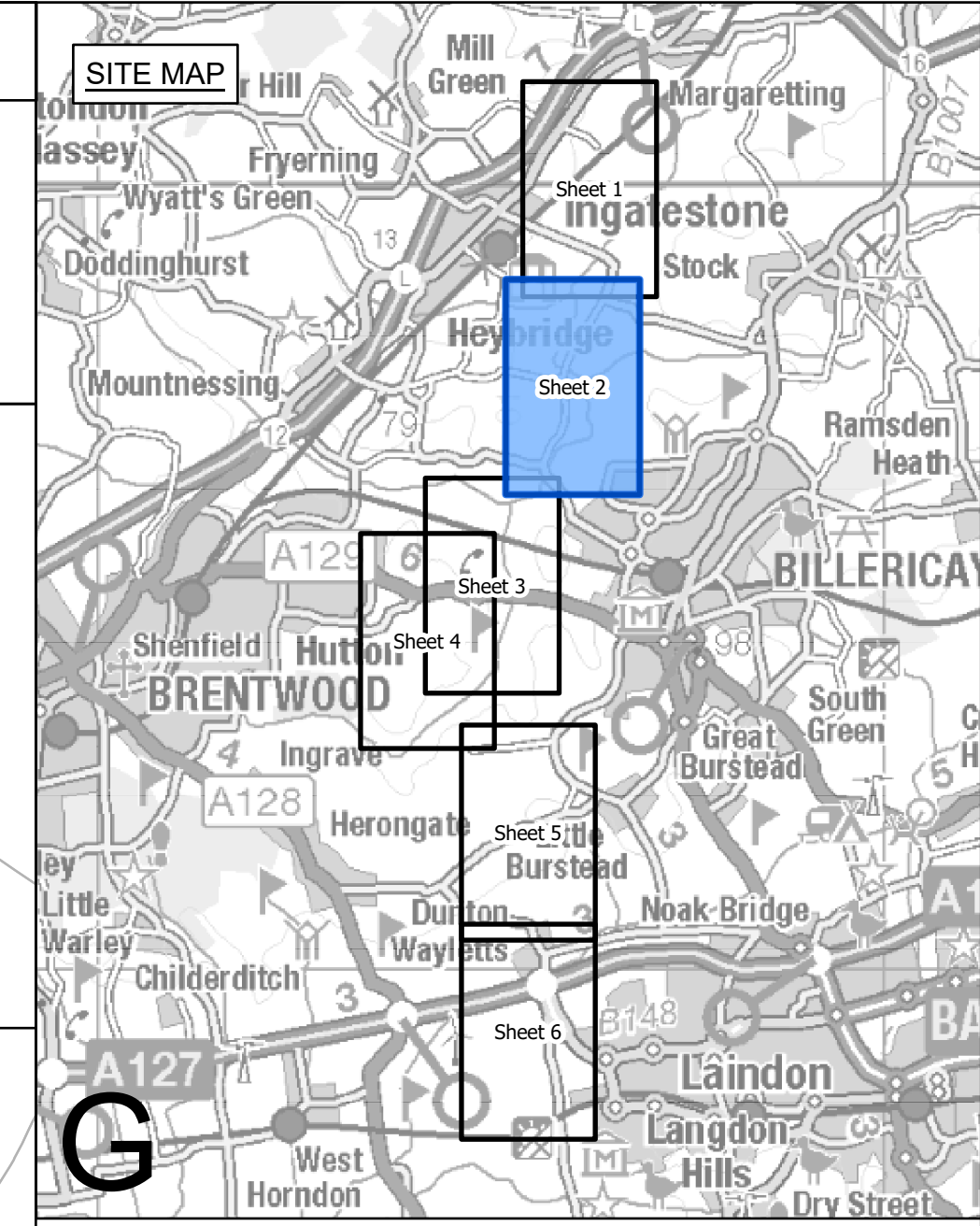

FOR CONTINUATION SEE SHEET 1

FOR CONTINUATION  
SEE SHEET 3

- Legend**
- - Local authority boundary
  - - Section boundary & local authority boundary
  - - Section boundary
  - - Sheet index cutlines
  - Commencement of work
  - Termination of work
  - Order Limits
  - Limits of deviation: overhead lines
  - Limits of deviation: underground cables
  - Limits of deviation: non-linear works
  - Proposed lattice pylons (not to scale)
  - Proposed pylon removal (not to scale)
  - Proposed pylon modification (not to scale)
  - Proposed temporary pylon (angle structures only) (not to scale)
  - Proposed overhead line
  - Third party overhead line to be removed
  - Third party existing overhead line (modified)
  - Third party proposed overhead line
  - Third party temporary overhead line diversion
  - Third party proposed underground cable centreline
  - Proposed substation extension

- Notes**
- These plans are indicative and the Project will sit within the Order Limits. Due to the need for future flexibility, National Grid will be applying for Order Limits and Limits of Deviation within its DCO, within which any final alignment would lie.
  - For additional detail on the plan suites, please refer to the Guide to Plans (document reference 2.0), located in the Volume 2 of the DCO application.
  - This drawing is scaled at paper size A0, therefore any prints taken at smaller sizes will affect accuracy of the measurement units and should not be scaled against.

Coordinate System: British National Grid  
Sheet X Centroid Coordinate: 566032 Sheet Y Centroid Coordinate: 197417



BACKGROUND MAPPING INFORMATION HAS BEEN REPRODUCED FROM THE ORDNANCE SURVEY BY PERMISSION OF ORDNANCE SURVEY OF THE CONTROLLER OF HIS MAJESTY'S STATIONERY OFFICE. © CROWN COPYRIGHT AND DATABASE RIGHTS (2025) LICENCE OS100024241 AND AC0000807948.

Issue	Date	Remarks	Drawn	Checked	Approved
B	JUN-2026	For deadline five	TMH	JPC	KR
A	AUG-2025	For DCO submission	MAB	JPC	KR

**Title**  
THE NATIONAL GRID (NORWICH TO TILBURY) ORDER  
WORKS PLANS  
REGULATION 5(2)(j)  
SECTION G (SHEET 2 OF 6,  
BRENTWOOD BOROUGH COUNCIL,  
CHELMSFORD CITY COUNCIL  
AND BASILDON BOROUGH COUNCIL)

**nationalgrid**

**PINS Application Number**  
EN020027

**National Grid Drawing Reference**  
AENC-LSTC-ENG-DWG-0003

Scale	Sheet Size	Sheet	Issue
1:2,500	A0	SHEET 2 OF 6	B

THE NATIONAL GRID (NORWICH TO TILBURY) ORDER  
WORKS PLANS  
REGULATION 5(2)(j)  
SECTION G (SHEET 3 OF 6,  
BRENTWOOD BOROUGH COUNCIL AND BASILDON BOROUGH COUNCIL)

Application Document 2.3

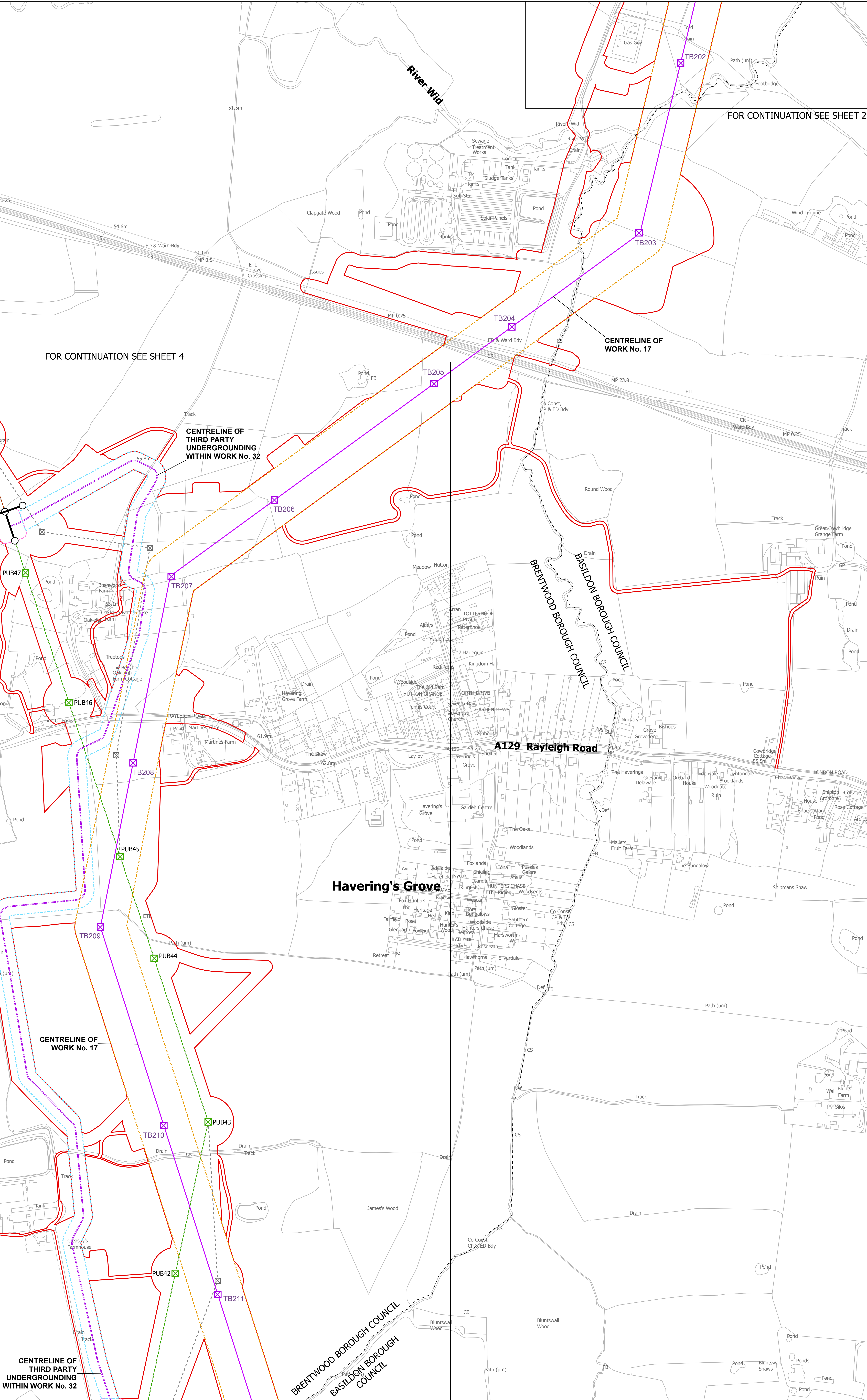
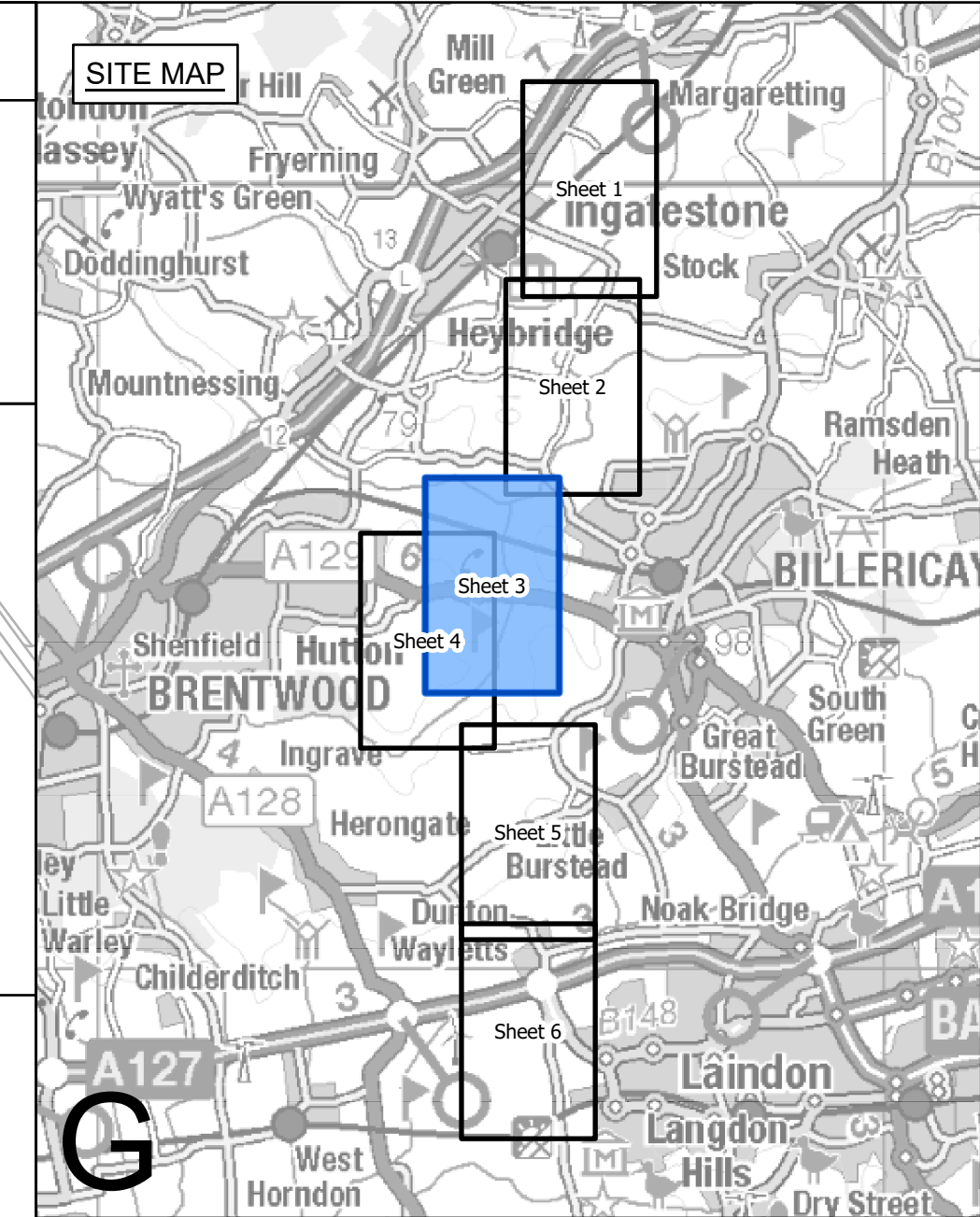
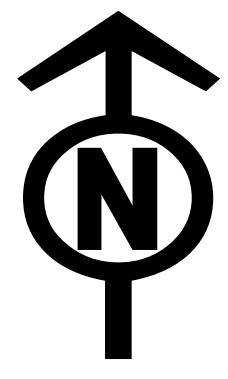

- Legend**
- - Local authority boundary
  - Section boundary & local authority boundary
  - Section boundary
  - Sheet index cutlines
  - Commencement of work
  - Termination of work
  - Order Limits
  - Limits of deviation: overhead lines
  - Limits of deviation: underground cables
  - Limits of deviation: non-linear works
  - Proposed lattice pylons (not to scale)
  - Proposed pylon removal (not to scale)
  - Proposed pylon modification (not to scale)
  - Proposed temporary pylon (angle structures only) (not to scale)
  - Proposed overhead line
  - Third party overhead line to be removed
  - Third party existing overhead line (modified)
  - Third party proposed overhead line
  - Third party temporary overhead line diversion
  - Third party proposed underground cable centreline
  - Proposed substation extension

**Notes**

- These plans are indicative and the Project will sit within the Order Limits. Due to the need for future flexibility, National Grid will be applying for Order Limits and Limits of Deviation within its DCO, within which any final alignment would lie.
- For additional detail on the plan suits, please refer to the Guide to Plans (document reference 2.0), located in the Volume 2 of the DCO application.
- This drawing is scaled at paper size A0, therefore any prints taken at smaller sizes will affect accuracy of the measurement units and should not be scaled against.

Coordinates System: British National Grid  
Sheet X Centroid Coordinate: 565005 Sheet Y Centroid Coordinate: 194885

BACKGROUND MAPPING INFORMATION HAS BEEN REPRODUCED FROM THE ORDNANCE SURVEY BY PERMISSION OF ORDNANCE SURVEY OF THE CONTROLLER OF HIS MAJESTY'S STATIONERY OFFICE. © CROWN COPYRIGHT AND DATABASE RIGHTS (2025) LICENCE OS100024241 AND AC0000807948.

B	JUN-2026	For deadline five	TMH	JPC	KR
A	AUG-2025	For DCO submission	MAB	JPC	KR
Issue	Date	Remarks	Drawn	Checked	Approved

**Title**  
THE NATIONAL GRID (NORWICH TO TILBURY) ORDER  
WORKS PLANS  
REGULATION 5(2)(j)  
SECTION G (SHEET 3 OF 6,  
BRENTWOOD BOROUGH COUNCIL  
AND BASILDON BOROUGH COUNCIL)

**nationalgrid**

**PINS Application Number**  
EN020027

**National Grid Drawing Reference**  
AENC-LSTC-ENG-DWG-0003

Scale	Sheet Size	Sheet	Issue
1:2,500	A0	SHEET 3 OF 6	B

THE NATIONAL GRID (NORWICH TO TILBURY) ORDER  
WORKS PLANS  
REGULATION 5(2)(j)  
SECTION G (SHEET 4 OF 6,  
BRENTWOOD BOROUGH COUNCIL AND BASILDON BOROUGH COUNCIL)

Application Document 2.3

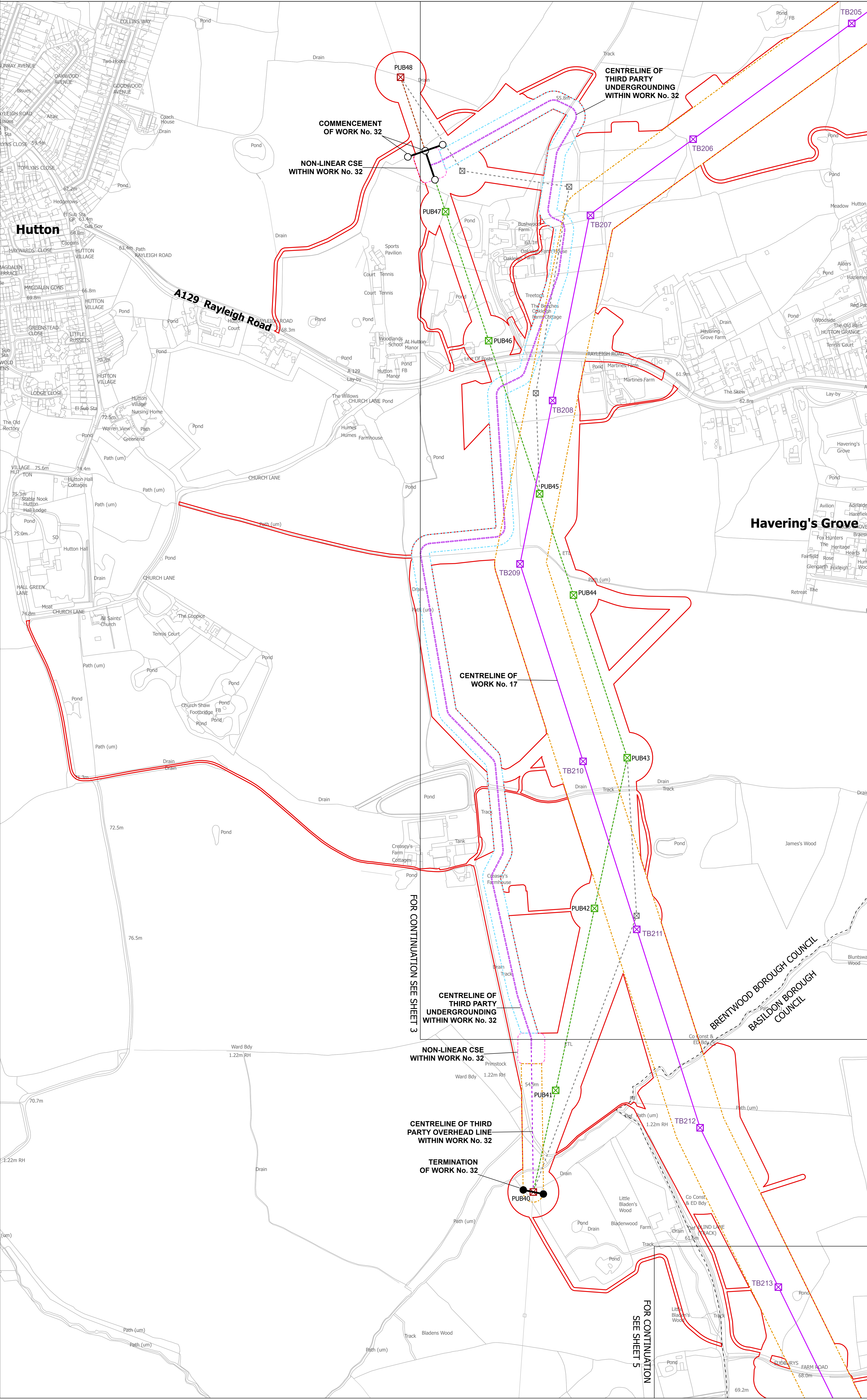
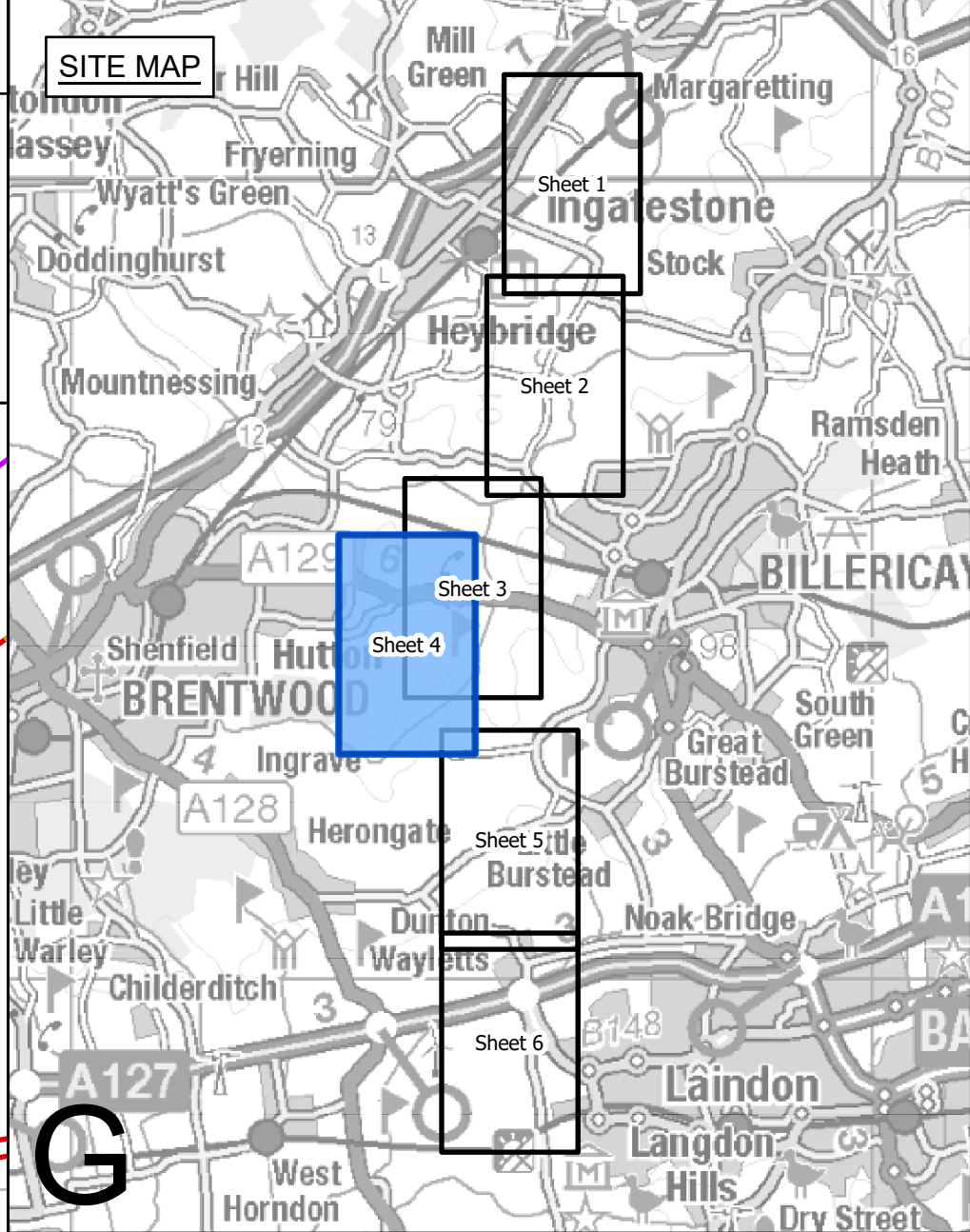
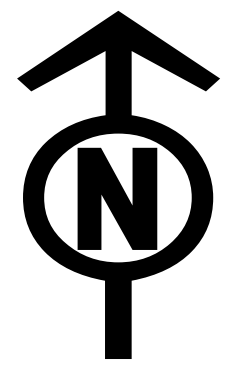

- Legend**
- - Local authority boundary
  - ▬ Section boundary & local authority boundary
  - ▬ Section boundary
  - Sheet index cutlines
  - Commencement of work
  - Termination of work
  - ▬ Order Limits
  - ▬ Limits of deviation: overhead lines
  - ▬ Limits of deviation: underground cables
  - ▬ Limits of deviation: non-linear works
  - ▬ Proposed lattice pylons (not to scale)
  - ▬ Proposed pylon removal (not to scale)
  - ▬ Proposed pylon modification (not to scale)
  - ▬ Proposed temporary pylon (angle structures only) (not to scale)
  - ▬ Proposed overhead line
  - ▬ Third party overhead line to be removed
  - ▬ Third party existing overhead line (modified)
  - ▬ Third party proposed overhead line
  - ▬ Third party temporary overhead line diversion
  - ▬ Third party proposed underground cable centreline
  - ▬ Proposed substation extension

- Notes**
1. These plans are indicative and the Project will sit within the Order Limits. Due to the need for future flexibility, National Grid will be applying for Order Limits and Limits of Deviation within its DCO, within which any final alignment would lie.
  2. For additional detail on the plan suites, please refer to the Guide to Plans (document reference 2.0), located in the Volume 2 of the DCO application.
  3. This drawing is scaled at paper size A0, therefore any prints taken at smaller sizes will affect accuracy of the measurement units and should not be scaled against.

Coordinate System: British National Grid  
Sheet X Centroid Coordinate: 564179 Sheet Y Centroid Coordinate: 194182

BACKGROUND MAPPING INFORMATION HAS BEEN REPRODUCED FROM THE ORDNANCE SURVEY BY PERMISSION OF ORDNANCE SURVEY OF THE CONTROLLER OF HIS MAJESTY'S STATIONERY OFFICE. © CROWN COPYRIGHT AND DATABASE RIGHTS (2025) LICENCE OS100024241 AND AC0000807948.

Issue	Date	Remarks	Drawn	Checked	Approved
B	JUN-2026	For deadline five	TMH	JPC	KR
A	AUG-2025	For DCO submission	MAB	JPC	KR

**Title**  
THE NATIONAL GRID (NORWICH TO TILBURY) ORDER  
WORKS PLANS  
REGULATION 5(2)(j)  
SECTION G (SHEET 4 OF 6,  
BRENTWOOD BOROUGH COUNCIL  
AND BASILDON BOROUGH COUNCIL)

**nationalgrid**  
PINS Application Number  
EN020027

National Grid Drawing Reference  
AENC-LSTC-ENG-DWG-0003

Scale	Sheet Size	Sheet	Issue
1:2,500	A0	SHEET 4 OF 6	B

THE NATIONAL GRID (NORWICH TO TILBURY) ORDER  
WORKS PLANS  
REGULATION 5(2)(j)  
SECTION G (SHEET 5 OF 6,  
BRENTWOOD BOROUGH COUNCIL AND BASILDON BOROUGH COUNCIL)

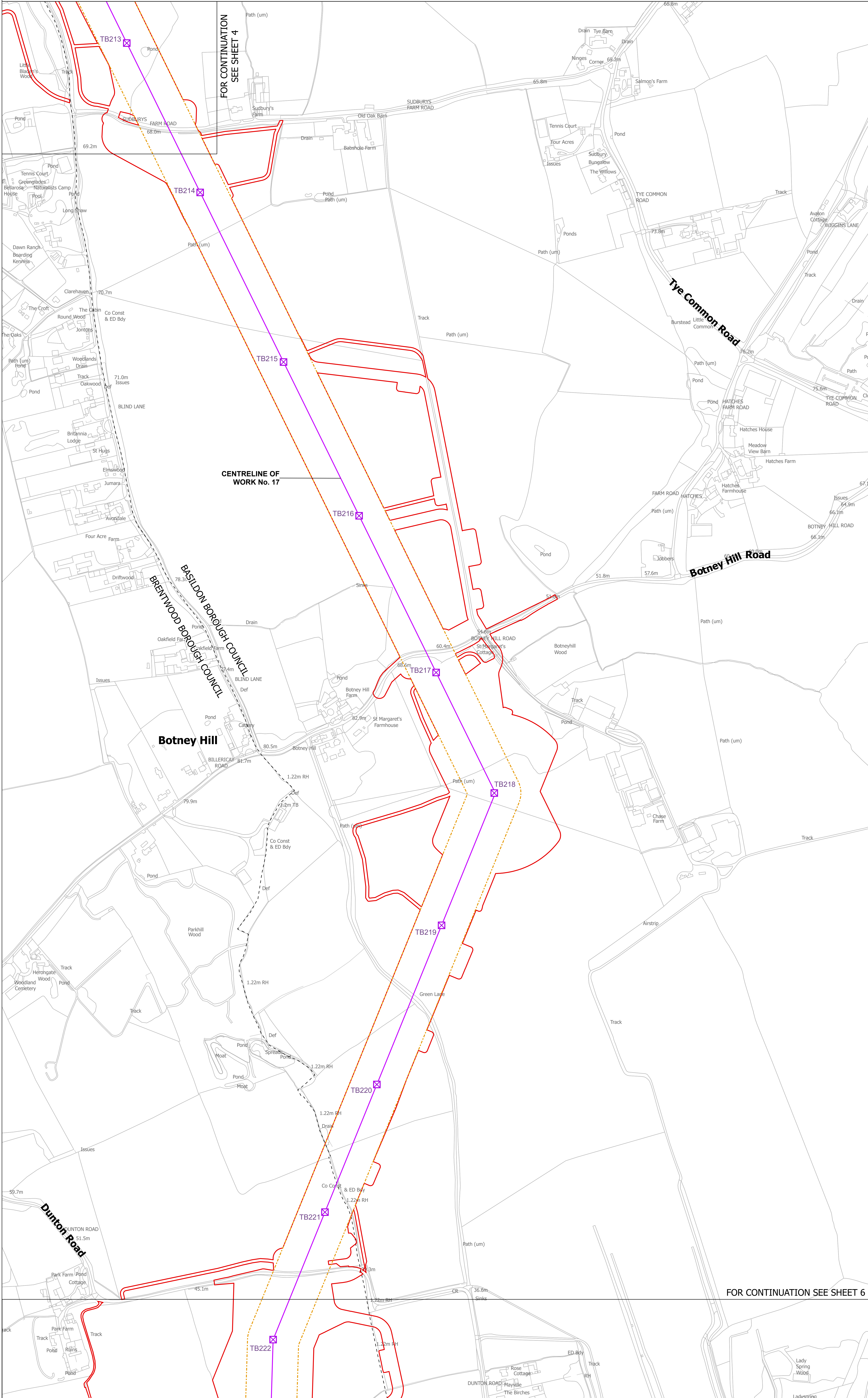
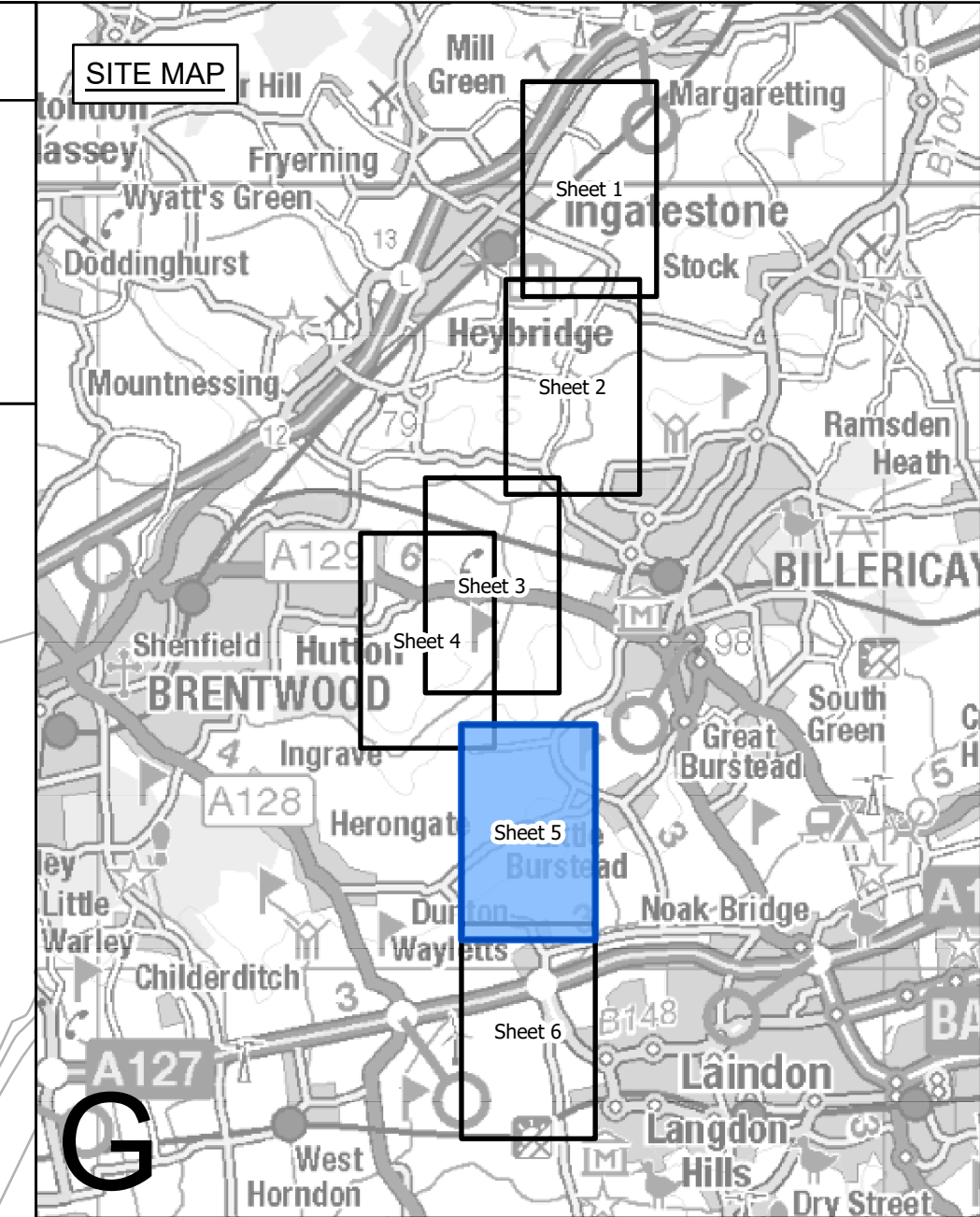
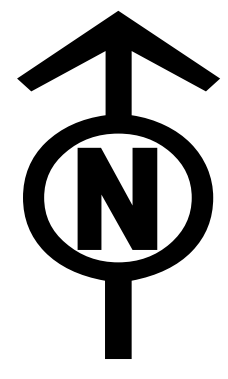

- Legend**
- Local authority boundary
  - Section boundary & local authority boundary
  - Section boundary
  - Sheet index cutlines
  - Commencement of work
  - Termination of work
  - Order Limits
  - Limits of deviation: overhead lines
  - Limits of deviation: underground cables
  - Limits of deviation: non-linear works
  - ⊗ Proposed lattice pylons (not to scale)
  - ⊗ Proposed pylon removal (not to scale)
  - ⊗ Proposed pylon modification (not to scale)
  - ⊗ Proposed temporary pylon (angle structures only) (not to scale)
  - Proposed overhead line
  - Third party overhead line to be removed
  - Third party existing overhead line (modified)
  - Third party proposed overhead line
  - Third party temporary overhead line diversion
  - Third party proposed underground cable centreline
  - Proposed substation extension

**Notes**

- These plans are indicative and the Project will sit within the Order Limits. Due to the need for future flexibility, National Grid will be applying for Order Limits and Limits of Deviation within its DCO, within which any final alignment would lie.
- For additional detail on the plan suites, please refer to the Guide to Plans (document reference 2.0), located in the Volume 2 of the DCO application.
- This drawing is scaled at paper size A0, therefore any prints taken at smaller sizes will affect accuracy of the measurement units and should not be scaled against.

Coordinates System: British National Grid  
Sheet X Centroid Coordinate: 565485 Sheet Y Centroid Coordinate: 191736

BACKGROUND MAPPING INFORMATION HAS BEEN REPRODUCED FROM THE ORDNANCE SURVEY BY PERMISSION OF ORDNANCE SURVEY OF THE CONTROLLER OF HIS MAJESTY'S STATIONERY OFFICE. © CROWN COPYRIGHT AND DATABASE RIGHTS (2025) LICENCE OS100024241 AND AC0000807948.

Issue	Date	Remarks	Drawn	Checked	Approved
B	JUN-2026	For deadline five	TMH	JPC	KR
A	AUG-2025	For DCO submission	MAB	JPC	KR

**Title**  
THE NATIONAL GRID (NORWICH TO TILBURY) ORDER  
WORKS PLANS  
REGULATION 5(2)(j)  
SECTION G (SHEET 5 OF 6,  
BRENTWOOD BOROUGH COUNCIL  
AND BASILDON BOROUGH COUNCIL)

**nationalgrid**

PINS Application Number  
EN020027

National Grid Drawing Reference  
AENC-LSTC-ENG-DWG-0003

Scale	Sheet Size	Sheet	Issue
1:2,500	A0	SHEET 5 OF 6	B

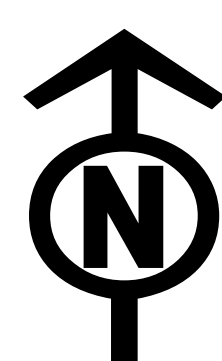

THE NATIONAL GRID (NORWICH TO TILBURY) ORDER  
WORKS PLANS  
REGULATION 5(2)(j)  
SECTION G (SHEET 6 OF 6,  
BRENTWOOD BOROUGH COUNCIL, BASILDON BOROUGH COUNCIL AND THURROCK COUNCIL)

Application Document 2.3

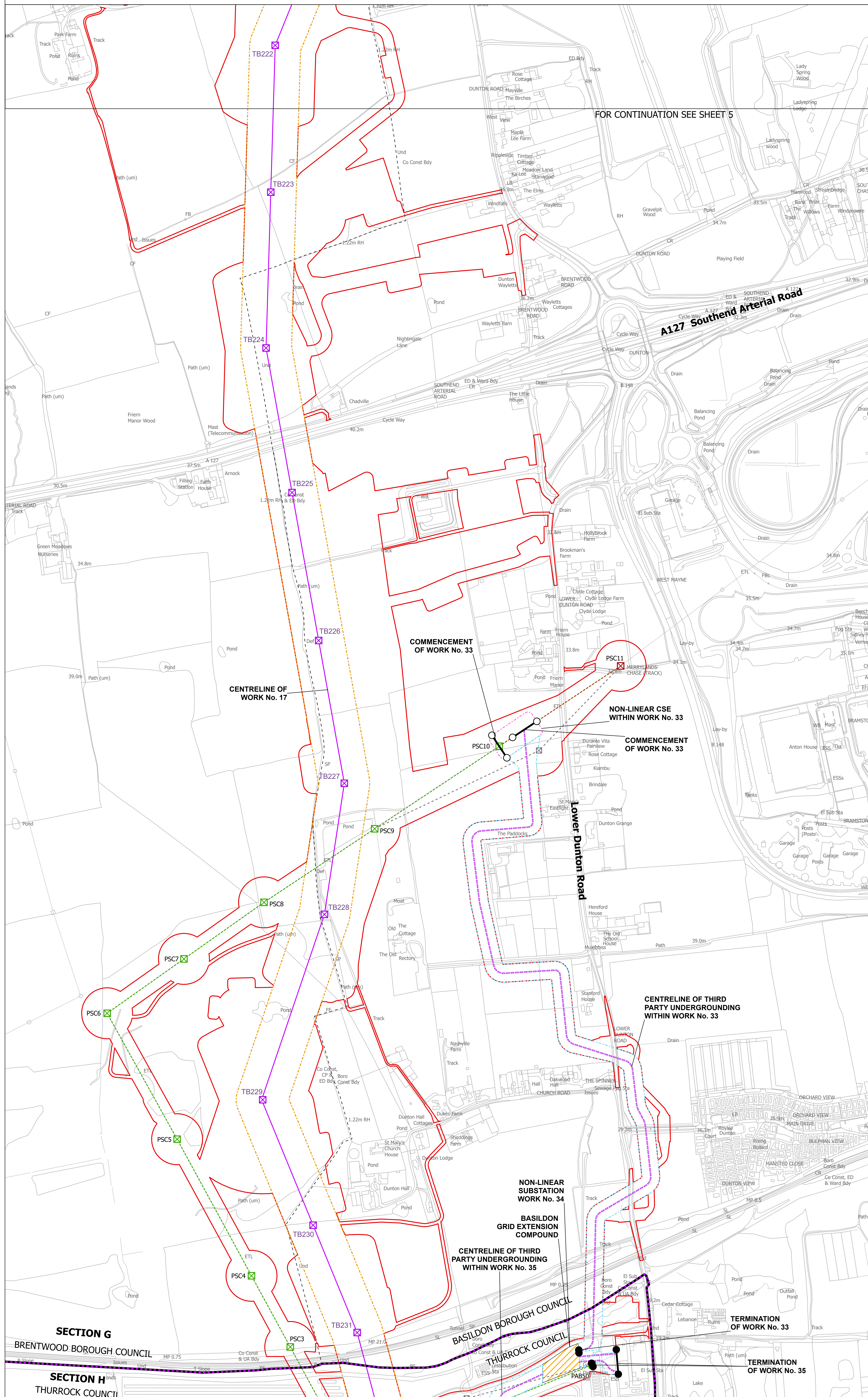
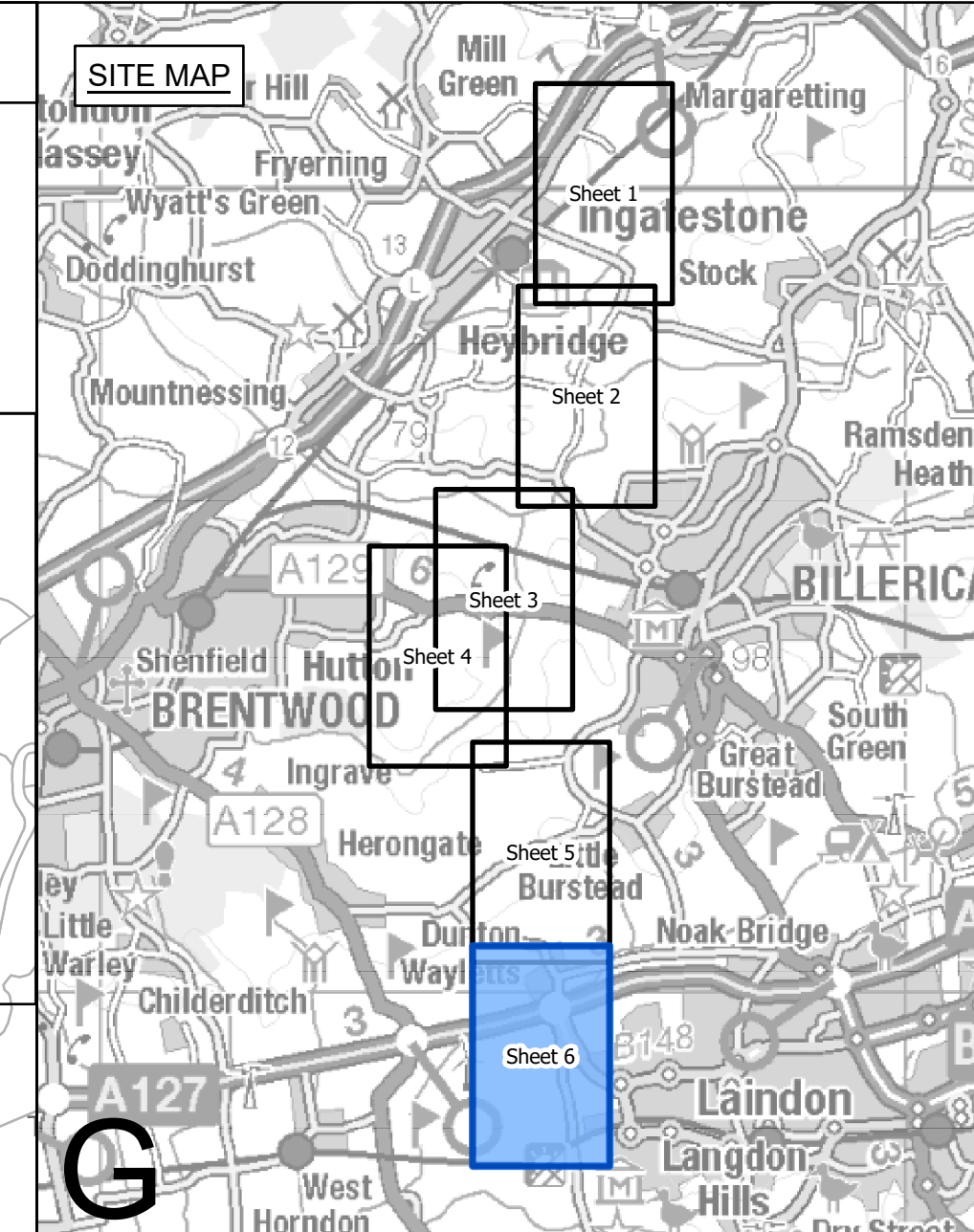

- Legend**
- - - Local authority boundary
  - - - Section boundary & local authority boundary
  - - - Section boundary
  - - - Sheet index cutlines
  - Commencement of work
  - Termination of work
  - Order Limits
  - Limits of deviation: overhead lines
  - Limits of deviation: underground cables
  - Limits of deviation: non-linear works
  - Proposed lattice pylons (not to scale)
  - Proposed pylon removal (not to scale)
  - Proposed pylon modification (not to scale)
  - Proposed temporary pylon (angle structures only) (not to scale)
  - Proposed overhead line
  - Third party overhead line to be removed
  - Third party existing overhead line (modified)
  - Third party proposed overhead line
  - Third party temporary overhead line diversion
  - Third party proposed underground cable centreline
  - Proposed substation extension

- Notes**
1. These plans are indicative and the Project will sit within the Order Limits. Due to the need for future flexibility, National Grid will be applying for Order Limits and Limits of Deviation within its DCO, within which any final alignment would lie.
  2. For additional detail on the plan suites, please refer to the Guide to Plans (document reference 2.0), located in the Volume 2 of the DCO application.
  3. This drawing is scaled at paper size A0, therefore any prints taken at smaller sizes will affect accuracy of the measurement units and should not be scaled against.

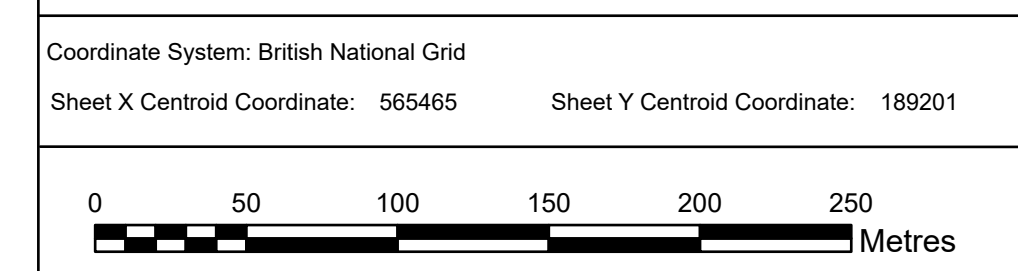

BACKGROUND MAPPING INFORMATION HAS BEEN REPRODUCED FROM THE ORDNANCE SURVEY BY PERMISSION OF ORDNANCE SURVEY OF THE CONTROLLER OF HIS MAJESTY'S STATIONERY OFFICE. © CROWN COPYRIGHT AND DATABASE RIGHTS (2025) LICENCE OS100024241 AND AC0000807948.

B	JUN-2026	For deadline five	TMH	JPC	KR
A	AUG-2025	For DCO submission	MAB	JPC	KR
Issue	Date	Remarks	Drawn	Checked	Approved

**Title**  
THE NATIONAL GRID (NORWICH TO TILBURY) ORDER  
WORKS PLANS  
REGULATION 5(2)(j)  
SECTION G (SHEET 6 OF 6,  
BRENTWOOD BOROUGH COUNCIL,  
BASILDON BOROUGH COUNCIL  
AND THURROCK COUNCIL)

**nationalgrid**

**PINS Application Number**  
EN020027

**National Grid Drawing Reference**  
AENC-LSTC-ENG-DWG-0003

Scale	Sheet Size	Sheet	Issue
1:2,500	A0	SHEET 6 OF 6	B

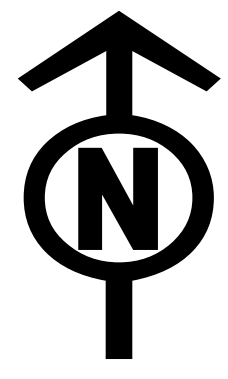

THE NATIONAL GRID (NORWICH TO TILBURY) ORDER  
WORKS PLANS  
REGULATION 5(2)(j)

Application Document 2.3

TABLE OF PARAMETERS - SECTION G (SHEET 1 OF 1,  
CHELMSFORD CITY COUNCIL, BRENTWOOD BOROUGH COUNCIL, BASILDON BOROUGH COUNCIL AND THURROCK COUNCIL)

SITE MAP

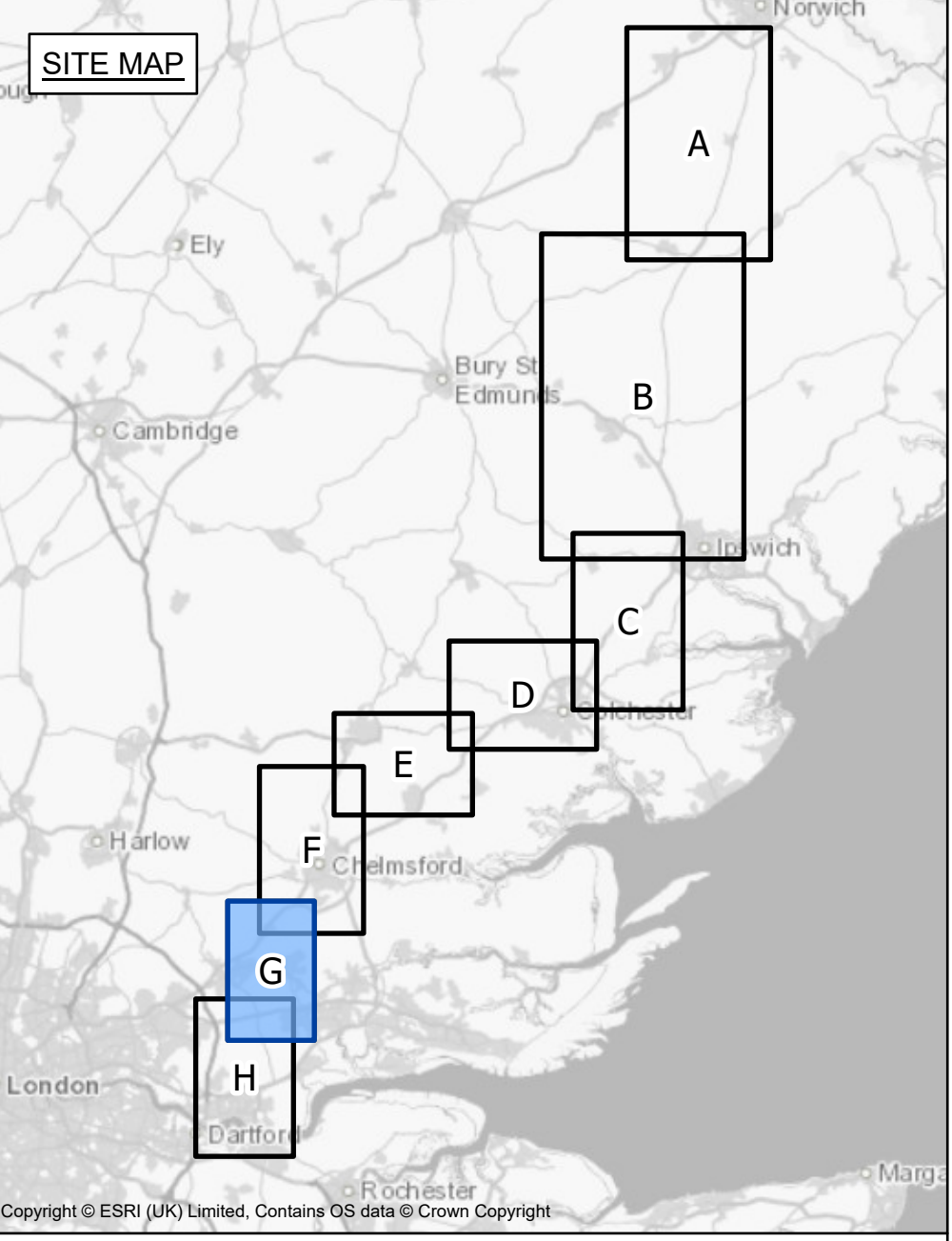

Infrastructure title/number	Infrastructure height above infrastructure foundation (m)	Upward extent of vertical limit of deviation (m)
TB186	59.8	6
TB187	62.8	6
TB188	65.8	6
TB189	53.8	6
TB190	50.8	6
TB191	46.1	6
TB192	53.8	6
TB193	48.7	6
TB194	50.8	6
TB195	47.8	6
TB196	46.1	6
TB197	47.8	6
TB198	50.8	6
TB199	50.8	6
TB200	46.1	6
TB201	53.8	6
TB202	53.8	6
TB203	43.1	6
TB204	62.8	6
TB205	60.7	6
TB206	50.8	6
TB207	52.1	6
TB208	56.8	6
TB209	51.7	6
TB210	56.8	6
TB211	47.8	6
TB212	51.7	6
TB213	53.8	6
TB214	53.8	6
TB215	50.8	6
TB216	56.8	6
TB217	53.8	6
TB218	46.1	6
TB219	50.8	6
TB220	47.8	6
TB221	50.8	6
TB222	45.7	6
TB223	50.8	6
TB224	51.7	6
TB225	53.8	6
TB226	50.8	6
TB227	51.7	6
TB228	54.7	6
TB229	55.1	6
TB230	50.8	6
TB231	57.7	6

Notes

- These plans show the Order Limits and potential location for the works. Due to the need for future flexibility, National Grid will be applying for Order Limits and Limits of Deviation within its Development Consent Order, within which any final alignments would lie.
- For additional detail on the plan suites, please refer to the Guide to Plans (document reference 2.0), located in the Volume 2 of the DCO application.
- This drawing is scaled at paper size A0, therefore any prints taken at smaller sizes will affect accuracy of the measurement units and should not be scaled against.
- The foundation of infrastructure is expected to extend above ground level between 0 m and 0.6 m dependant on the topography and geotechnical conditions.
- Gantries, located within a substation or cable sealing end compound, have a 15.0 m maximum height and an upward vertical limit of deviation of 10% of that height.
- Non-linear infrastructure located within substations and cable sealing end compounds have a 15.0 m maximum height and an upward vertical limit of deviation of 10% of that height, excluding rooftop equipment, such as but not limited to, lightning protection, aerials, fall arrest systems, and handrails.
- The voltage of the TB overhead line is 400 kV.

Coordinate System: British National Grid  
Sheet X Centroid Coordinate: 56210 Sheet Y Centroid Coordinate: 194573

BACKGROUND MAPPING INFORMATION HAS BEEN REPRODUCED FROM THE ORDINANCE SURVEY BY PERMISSION OF ORDNANCE SURVEY OF THE CONTROLLER OF HIS MAJESTY'S STATIONERY OFFICE. © CROWN COPYRIGHT AND DATABASE RIGHTS (2025) LICENCE OS100024241 AND AC0000807948.

Issue	Date	Remarks	Drawn	Checked	Approved
B	JUN-2026	For deadline five	TMH	JPC	KR
A	AUG-2025	For DCO submission	MAB	JPC	KR

Title  
THE NATIONAL GRID  
(NORWICH TO TILBURY) ORDER  
WORKS PLANS  
REGULATION 5(2)(j)  
TABLE OF PARAMETERS -  
SECTION G (SHEET 1 OF 1,  
CHELMSFORD CITY COUNCIL,  
BRENTWOOD BOROUGH COUNCIL,  
BASILDON BOROUGH COUNCIL  
AND THURROCK COUNCIL)



PINS Application Number  
EN020027

National Grid Drawing Reference  
AENC-LSTC-ENG-DWG-0003

Scale	Sheet Size	Sheet	Issue
N/A	A0	SHEET 1 OF 1	B



National Grid plc  
National Grid House,  
Warwick Technology Park,  
Gallows Hill, Warwick.  
CV34 6DA United Kingdom

Registered in England and Wales  
No. 4031152  
[nationalgrid.com](http://nationalgrid.com)